

Produktinformation Product information

LINEPOINT I LED EIN- BZW. ZWEIFUNKTIONSLEUCHE SINGLE RESP. DOUBLE FUNCTION LAMP

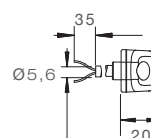
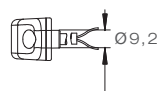
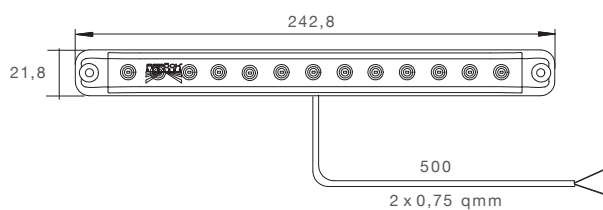
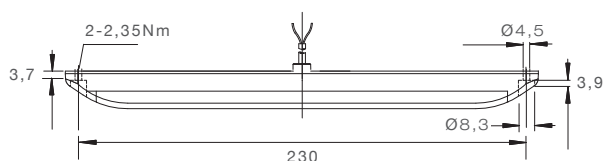
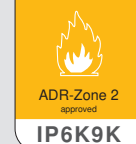

Maßnahmen / unit of measurement: mm

PRODUKTVORTEILE/NUTZEN

- LED Leuchte
- schlankes Design
- beliebig kombinierbar
- Anbau Horizontal / Vertikal möglich

PRODUCT BENEFITS

- LED lamp
- slim design
- combinable adjustment with other light functions
- mounting opportunity horizontal / vertical

LINEPOINT I LED

TECHNISCHE DATEN / TECHNICAL FACTS											
SPANNUNGSBEREICH: VOLTAGE RANGE:	9 - 32 V										
	<table border="1"> <tr> <td>Rücklicht: <i>Taillight:</i></td> <td>0,5 Watt</td> </tr> <tr> <td>Blinker: <i>Direction indicator:</i></td> <td>2,0 Watt</td> </tr> <tr> <td>Nebelleuchte: <i>Foglamp:</i></td> <td>3,4 Watt</td> </tr> <tr> <td>Rückfahrcheinwerfer: <i>Reversing lamp:</i></td> <td>3,5 Watt</td> </tr> <tr> <td>Bremsleuchte: <i>Stoplamp:</i></td> <td>2,5 Watt</td> </tr> </table>	Rücklicht: <i>Taillight:</i>	0,5 Watt	Blinker: <i>Direction indicator:</i>	2,0 Watt	Nebelleuchte: <i>Foglamp:</i>	3,4 Watt	Rückfahrcheinwerfer: <i>Reversing lamp:</i>	3,5 Watt	Bremsleuchte: <i>Stoplamp:</i>	2,5 Watt
Rücklicht: <i>Taillight:</i>	0,5 Watt										
Blinker: <i>Direction indicator:</i>	2,0 Watt										
Nebelleuchte: <i>Foglamp:</i>	3,4 Watt										
Rückfahrcheinwerfer: <i>Reversing lamp:</i>	3,5 Watt										
Bremsleuchte: <i>Stoplamp:</i>	2,5 Watt										
ANSCHLUSS: CONNECTION:	Kabel mit offenem Ende <i>Cable with open end</i>										
GEWICHT: WEIGHT:	110 g										
MATERIAL: MATERIAL:	<table border="1"> <tr> <td>Lichtscheibe <i>Lens</i></td> <td>PMMA</td> </tr> <tr> <td>Gehäuse <i>Housing</i></td> <td>PC/ABS</td> </tr> </table>	Lichtscheibe <i>Lens</i>	PMMA	Gehäuse <i>Housing</i>	PC/ABS						
Lichtscheibe <i>Lens</i>	PMMA										
Gehäuse <i>Housing</i>	PC/ABS										
TEMPERATURBEREICH: TEMPERATURE RANGE:	-30°C ~ +50°C										
IP-KLASSE: IP-RATING:	IP6K9K										
EMV-ABNAHME: EMC APPROVAL:	E24 1608										
ECE-ABNAHME: ECE- APPROVAL:	E24 6109 / E24 0145										
DIMENSION: DIMENSION:	L= 243 mm, B = 22 mm, T = 20 mm										

BESCHREIBUNG / DESCRIPTION	OEM	AM
Linepoint I, 0,5 m Kabel mit offenem Ende Linepoint I, 0.5 m open end cable		
Linepoint I Rück-, Brems-, und Blinklicht Linepoint I tail, stop and direction indicator lamp	-	-
Linepoint I Rück-, und Bremslicht horizontal/vertikal Linepoint I tail and stop lamp horizontal/vertical	31-9220-007	31-9220-001
Linepoint I Blinklicht horizontal/vertikal Linepoint I direction indicator horizontal/vertical	31-9221-007	31-9221-001
Linepoint I Nebelschlussleuchte horizontal/vertikal Linepoint I fog lamp horizontal/vertical	37-9220-007	37-9220-001
Linepoint I Rückfahrleuchte horizontal/vertikal Linepoint I reversing lamp horizontal/vertical	38-9220-007	38-9220-001
Linepoint I 3. Bremsleuchte horizontal/vertikal Linepoint I 3rd stop lamp horizontal/vertical	31-8920-007	31-8920-001

LINEPOINT I LED

BESCHREIBUNG / DESCRIPTION	OEM	AM
<p>Linepoint I mit ASS3 Verbinder Linepoint I with ASS3 connector</p> <p>Linepoint I 0,5 m, Rück-, und Bremslicht horizontal/vertikal Linepoint I 0.5 m, tail and stop lamp horizontal/vertical</p> <p>Linepoint I 0,5 m, Blinklicht horizontal/vertikal Linepoint I 0.5 m, direction indicator horizontal/vertical</p> <p>Linepoint I 0,5 m, Nebelschlussleuchte horizontal/vertikal Linepoint I 0.5 m, fog lamp horizontal/vertical</p> <p>Linepoint I 0,5 m, Rückfahrleuchte horizontal/vertikal Linepoint I 0.5 m, reversing lamp horizontal/vertical</p>	<p>31-9207-047</p> <p>31-9207-057</p> <p>37-9207-017</p> <p>38-9207-017</p>	<p>31-9207-041</p> <p>31-9207-051</p> <p>37-9207-011</p> <p>38-9207-011</p>
<p>Verteiler für Linepoint I Junction box for Linepoint I</p> <p>Verteiler rechts 0,2 m, IN: 7 pol. ASS2, OUT: 4 x ASS3 Junction box right 0.2 m, IN: 7 pin ASS2, OUT: 4 x ASS3</p> <p>Verteiler links 0,2 m, IN: 7 pol. ASS2, OUT: 4 x ASS3 Junction box left 0.2 m, IN: 7pin ASS2, OUT: 4 x ASS3</p>	<p>76-9028-007</p> <p>76-9027-007</p>	<p>76-9028-001</p> <p>76-9027-001</p>
<p>Linepoint I Zubehör Linepoint I accessories</p> <p>Linepoint I Gummiauflage horizontal/vertikal Linepoint I rubber pad horizontal/vertical</p>	<p>15-5111-407</p>	<p>15-5111-404</p>

